



RP₄₈Q

High Performance Preamps for active or passive ribbons

With Curve Shaping Your sound right now at your fingertips



- *Curve Shaper* for extended highs and articulate lows
- DC coupled *No Load™* inputs for classic ribbons
- AC coupled inputs for phantom powered mics
- 80 dB of quiet JFET gain

RP₄₈Q

Hear Your Ribbon Microphones Like You've Never Been Able to Hear Them Before.

Mic preamps in general are built much more with condenser mics in mind than ribbon mics, so it shouldn't be surprising if the impedances and individual component specifications of even high-end mic pres aren't really designed to get the best possible sound out of a ribbon mic. Could it be possible that you've never actually heard everything your ribbon mics are capable of?

As ribbon mics continue to gain in popularity, the RPQ is designed to fill this niche for today's ribbon users. We designed the entire circuitry of the RPQ to optimize the performance of ribbon mics, from vintage to modern, both powered and passive. As a result, the RPQ allows the full glory of the "ribbon tone" to shine through in a way you've never heard before.

The RPQ's delivers the bandwidth and quietness needed for high resolution recording. JFET circuit topology delivers all the dynamics, subwoofer bass, and fast transients that your ribbons can record. *No Load™* input impedance above 10,000 Ω means the RPQ won't load down a mic changing its sound. *Low Energy Storage™* circuit design instantly recovers from overloads for superior dynamic performance.

In addition to the RPQ's optimized circuitry, the Curve Shaping features offer an organic option for sculpting your ribbon mic's output at the start of the signal path. Switchable and tunable low frequency (LF) and high frequency (HF) contour controls allow you to tame proximity problems and provide HF extension and slope control.

The AEA RPQ with Curve Shaping is the tool of choice for all ribbon microphones because it is tailored to the needs of ribbon microphones in a way that other mic preamps are not. The RPQ will allow the best performance of all your ribbons to shine through, with a cleaner, more open, and more responsive sound than you've ever heard before.

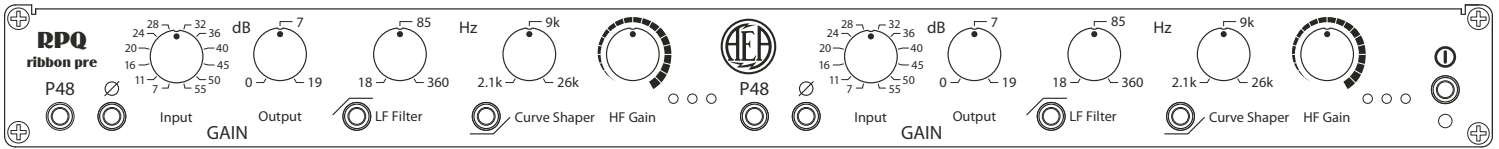

RPQ front panel

RPQ Electronics Specifications

- 80 dB of gain at 1 kHz, balanced-in to balanced-out
- A-weighted RMS noise < 2 dB, EIN < 129 dBu / 150Ω
- Frequency response -3 dB < 1 Hz and > 200 kHz
- <.02 % THD at 1 kHz, 22 Hz to 22 kHz bandwidth
- Balanced mic input impedance > 10 kΩ
- DC-coupled inputs protected from external P48 DC
- AC-coupled inputs with switchable P48 phantom power
- Twelve position stepped gain control from 7 to 55 dB
- Trim gain continuously adjustable from 0 to +19 dB
- Switched LF trim: -3dB points tuneable from 18 to 350 Hz
- Switched HF Curve Shaper tuneable from 2 to 26 kHz
- XLR out has 6 dB gain, balanced or unbalanced load
- XLR maximum into 600 Ω: +28 balanced, +22 unbalanced
- 1/4" TRS max output unbalanced +22 dBu, 100 kΩ load
- Pin 2 high on XLRs, tip high on 1/4" TRS jacks
- Green LED snaps on at ~ -5 dBu, Red at ~ +20 dBu
- Yellow LED brightens from ~ 0 to +20 dBu

RPQ Physical Details

- P48 Phantom & Polarity-Invert pushbutton switches
- Rotary potentiometers (pots) detented at 12 o'clock
- Grayhill series 71 stepped gain switch
- LF Cut pushbutton switch and one potentiometer
- HF Boost pushbutton switch and two potentiometers
- Pushbutton power switch, LED power indicator
- Internal toroidal transformer with linear regulators
- Male recessed IEC power plug and fuse holder
- Silkscreened and clear-coated panel markings
- Metallic blue and steel gray powder coat finish
- Detachable matching blue powdercoat rack ears
- One rack space aluminum and steel chassis
- Machined aluminum knobs, color coded push buttons
- Chassis: 17.25" wide, 11" deep, by 1.7" high
Metric: 44 cm wide, 28 cm deep, by 4.3 cm high
- Weight: 6.75 pounds, Metric: 3.1 Kg

Specifications as of Jan 15, 2009, and are subject to change.

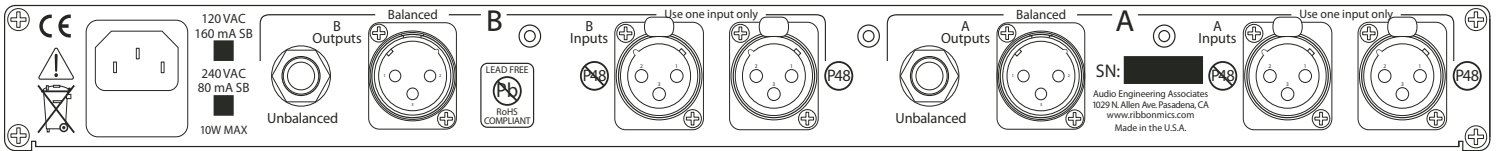

RPQ rear panel

